

~~Ezra Jones~~  
Wm Knox  
CL 4-197

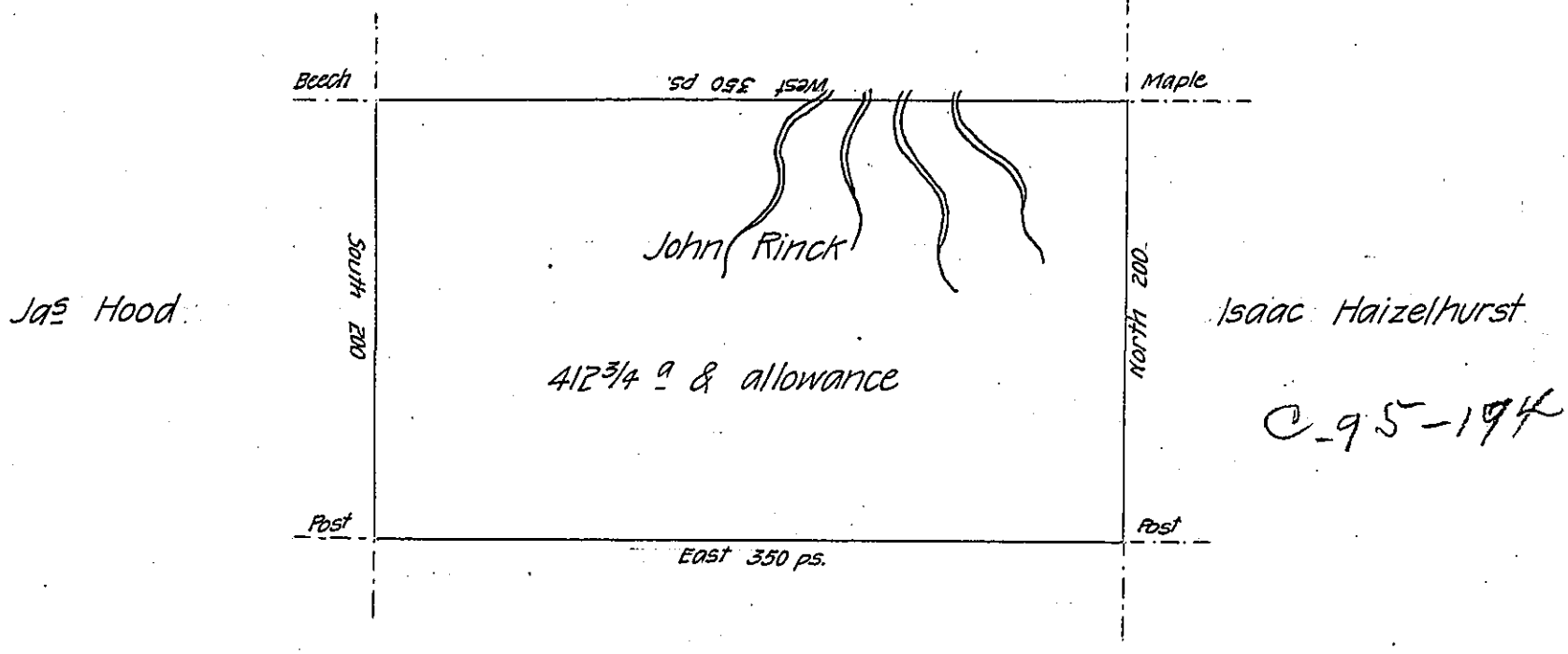

James Hartley C 95-196

A draught of a tract of land called — situate on the Waters of Snake Creek, adjoining land of James Hartley and others in Stoke Township Northumberland County Surveyd on the 25<sup>th</sup> day of Sep<sup>r</sup> 1786 for John Rinck, by virtue of his warrant dated the 18<sup>th</sup> day of July 1786 Containing four hundred and twelve acres and <sup>3</sup>/<sub>4</sub> & allowance of Six P. Cent for roads &c

By Wm Gray D. S.

To John Lukens Esq<sup>r</sup>  
Surveyor Gen<sup>l</sup>

Now Luzerne County.

IN TESTIMONY that the above is a copy of the original remaining on file in the Department of Internal Affairs of Pennsylvania, made conformably to an Act of Assembly approved the 16th day of February, 1833, I have hereunto set my Hand and caused the Seal of said Department to be affixed at Harrisburg, this thirtieth day of November 1906.

*Hoac R Brown*  
Secretary of Internal Affairs.